

DESCRIPTION: BUNK BED

<div>1 Hr</div> <div>APPROXIMATE ASSEMBLY TIME</div>	<div>2 PERSON ASSEMBLY</div> <div></div>	<div>FLOOR AREA 2.5M X 2.5M</div> <div></div> <div>REQUIRED ASSEMBLY SPACE</div>	<div>CEILING HEIGHT 2.5M</div>
--	--	---	------------------------------------

<div>REQUIRED ASSEMBLY TOOLS</div>	<div></div>
------------------------------------	--

ASSEMBLED DIMENSIONS SINGLE BED FRAME

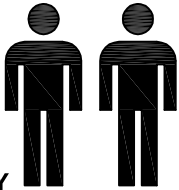
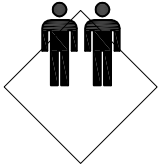
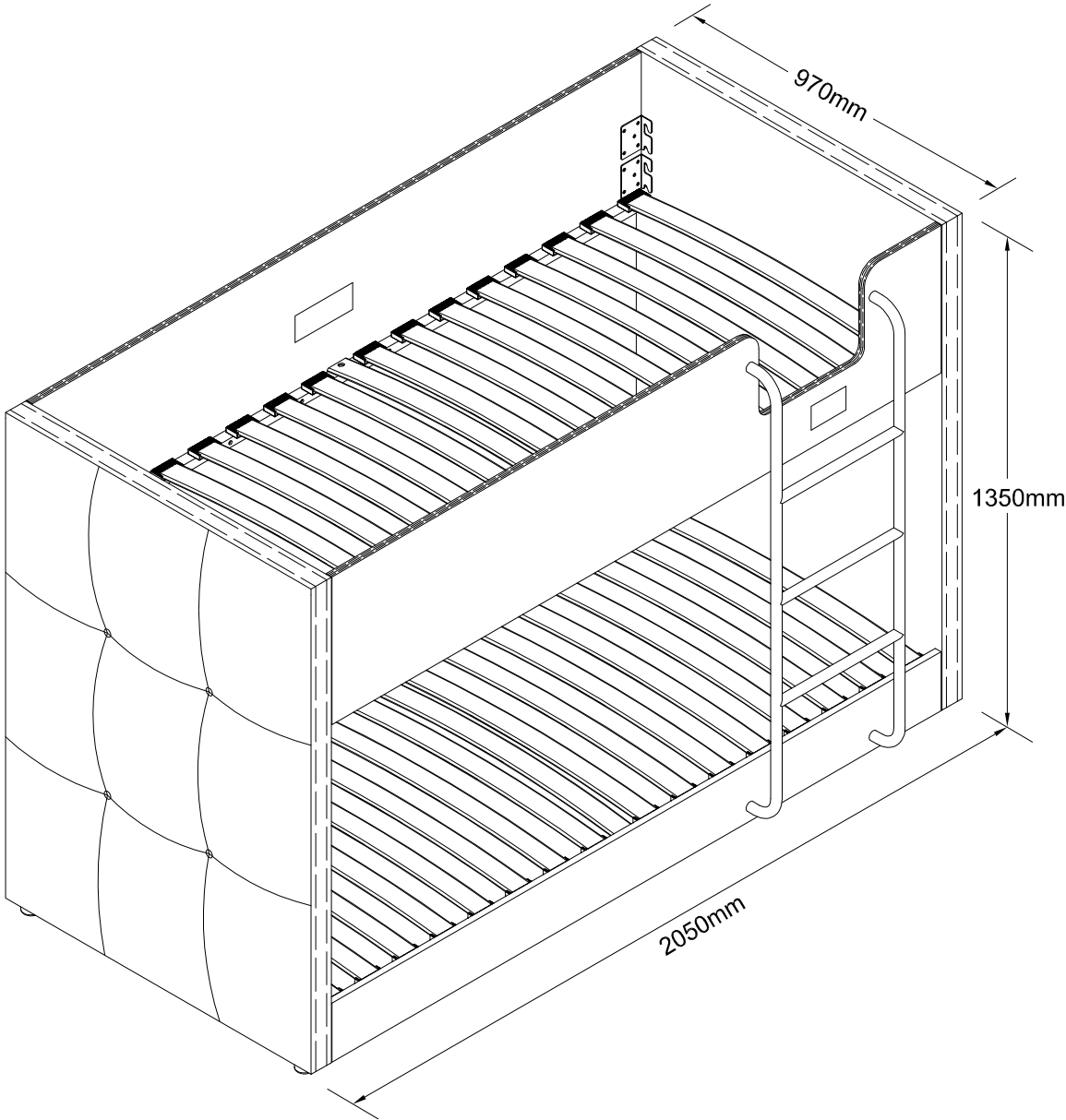

Internal size for mattress = 900mm x 1900mm

PARTS LIST

NO.	PART LISTS	QTY
1	ENDBOARD	2
2	TOP SIDE RAIL A	1
3	TOP SIDE RAIL B	1
4	BOTTOM SIDE RAIL	1
4-1	BOTTOM SIDE RAIL	1
5	TIE RAIL	2
6	METAL LADDER	1
7	POSTURE SLATS	32

CARTON 1 CONSISTS OF PART : 1
CARTON 2 CONSISTS OF PART : 2,3,4,4-1,5 & HARDWARE
CARTON 3 CONSISTS OF PART : 6
CARTON 4 CONSISTS OF PART : 7 & SLAT CAPS

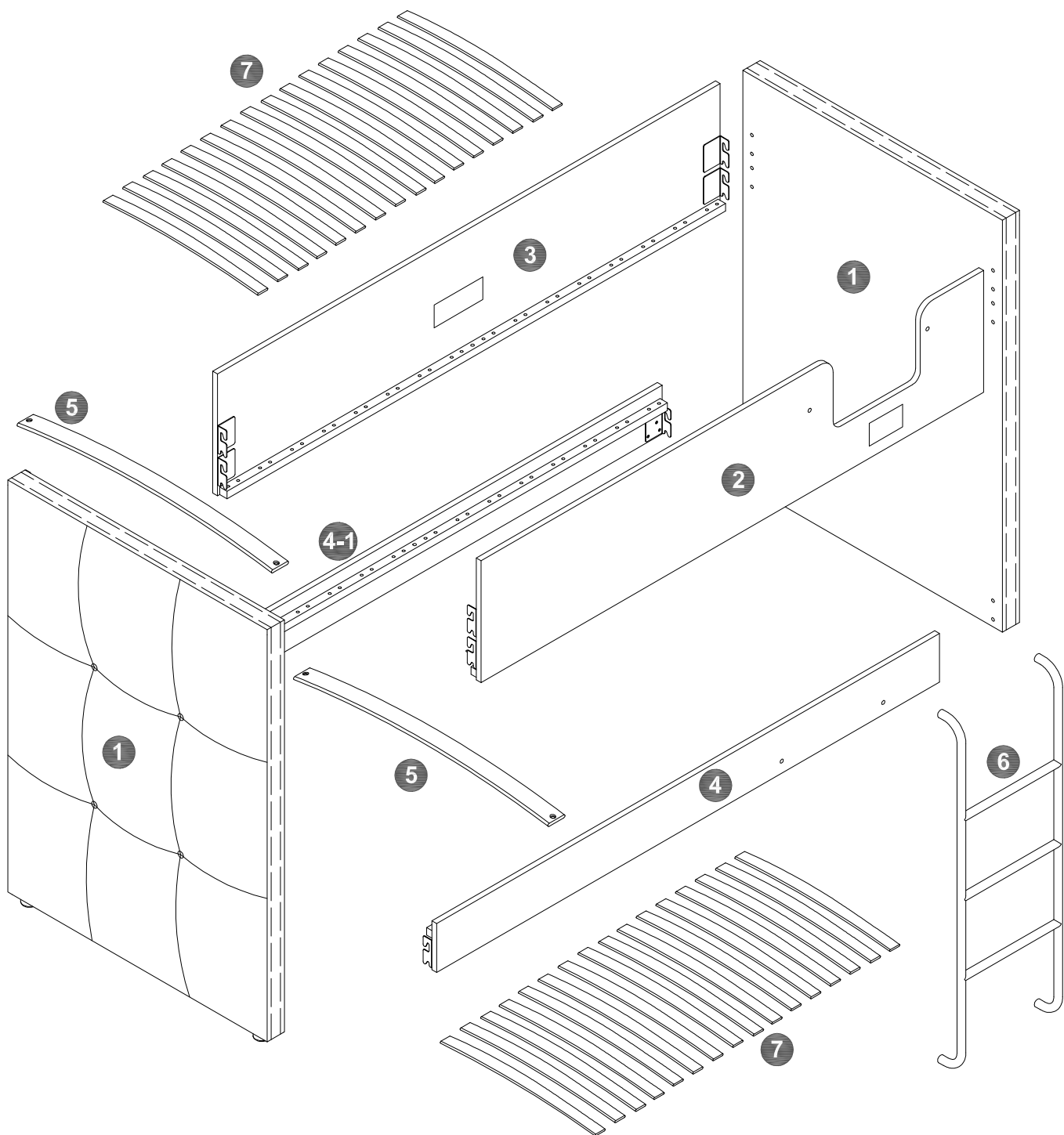

HARDWARE LIST



64x

A
END CAP

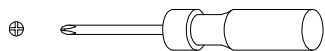

1x

B
SCREW DRIVER
(4" x 5mm)

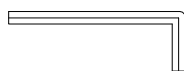

1x

C
ALLEN KEY M5

IMPORTANT-READ CAREFULLY-RETAIN FOR FUTURE REFERENCE!

This product complies with EN747-2 : 2012 + A1 : 2015

WARNING-This bed must be placed in a room that has good ventilation in order to keep the humidity low and to prevent mould in and around the bed.

WARNING-High beds & the upper bed of bunk beds are **not suitable** for children under six years due to risk of injury from falls. Do not allow children under 6 years to sleep or access the top bunk.

WARNING-Allow only one person on the top bunk.

WARNING-Do not allow children to play on bunk beds.

WARNING-Make sure your child is taught how to use bunk beds safely.

WARNING-Assemble the bunk bed properly following manufacturers instructions.

WARNING-Do not place bunk beds near windows, curtains/blinds or within 2 metres of a ceiling light fitting.

WARNING-Check regularly to make sure the bed frame is sturdy and free from signs of wear and tear.

WARNING-Check for any gaps that may trap fingers, limbs and heads.

WARNING-Make sure there is nothing sticking out from the bed which could catch in your child's clothing.

WARNING-Bunk beds & high beds can present a serious risk of injury from strangulation if not used correctly. Never attach or hang items to any part of the bunk bed that are not designed to be used with the bed. For example, ropes, strings, cords, hooks, belts and bags.

WARNING-Children can become trapped between the bed & the wall, a roof pitch, the ceiling, adjoining pieces of furniture (e.g. cupboard) and the like. To avoid risk of serious injury the distance between the top safety barrier and the adjoining structure shall not exceed 75mm or shall be more than 230mm.

WARNING-Do not use the bunk bed / high bed if any structural part is broken or missing.

WARNING-Do not use mattress more than 6 inches / 150mm thickness.

WARNING-Keep the area under the bunk bed clear of furniture, toys and other sharp objects.

Please periodically check all fittings and re-tighten as necessary.

Please do not jump on your furniture.

Periodically check the condition of your bed slats and plastic locating caps to ensure they are in good condition and have not become loose.

This is very important when moving your bed. It is best to lift the bed, and never to drag it.

Top Tips before you start!

1. Please check that all parts are present before you start the assembly of your furniture, as once assembled, the furniture is exempt from our home approval policy.
2. For ease and speed of assembly, we recommend that before you commence each step of the assembly, that you identify all the parts required for that step.
3. For larger items, please ensure that you have sufficient space and people (as indicated on page 1) to assemble your product safely.
4. We recommend that, where possible, all items are assembled near to the area in which they will be placed in use, to avoid moving the product unnecessarily once assembled.
5. For the protection of your furniture, particularly items of high gloss finish, we recommend that the product is placed on a protected surface during assembly to prevent any damage.
6. During assembly please take care not to over-tighten any fittings, as this may damage the product.

STEP 1

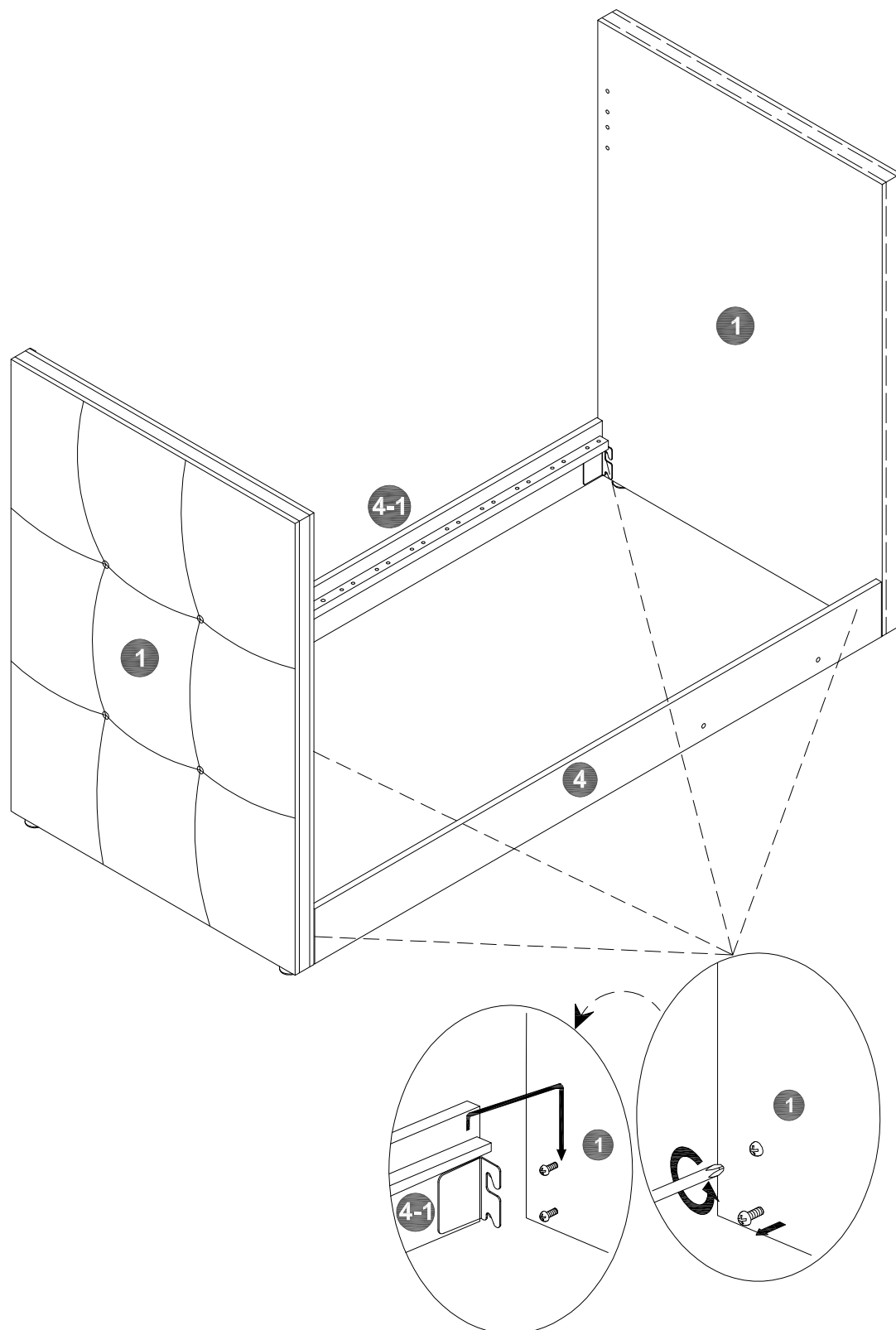

STEP 2

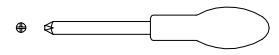

B x 1

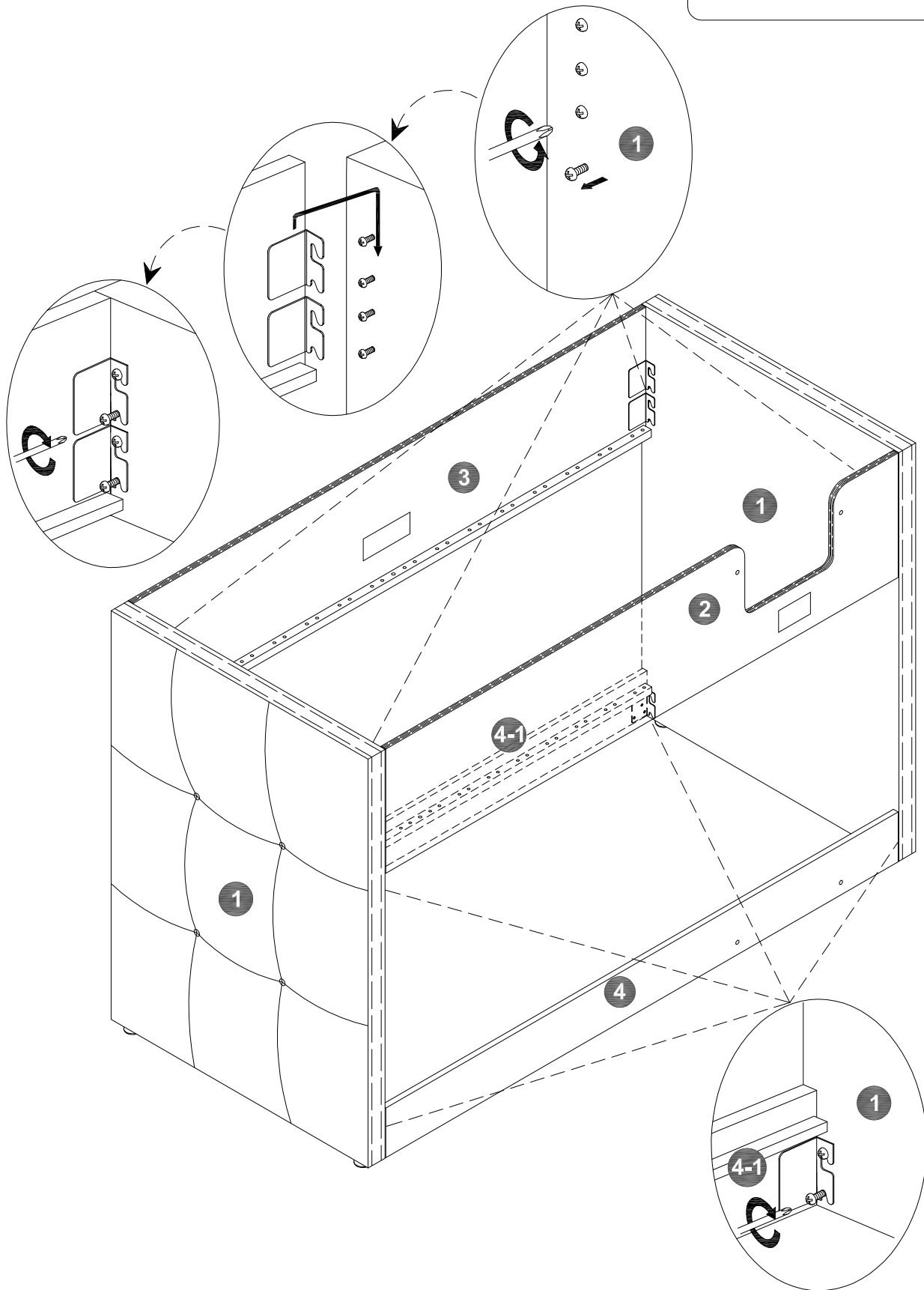

STEP 3



C x 1

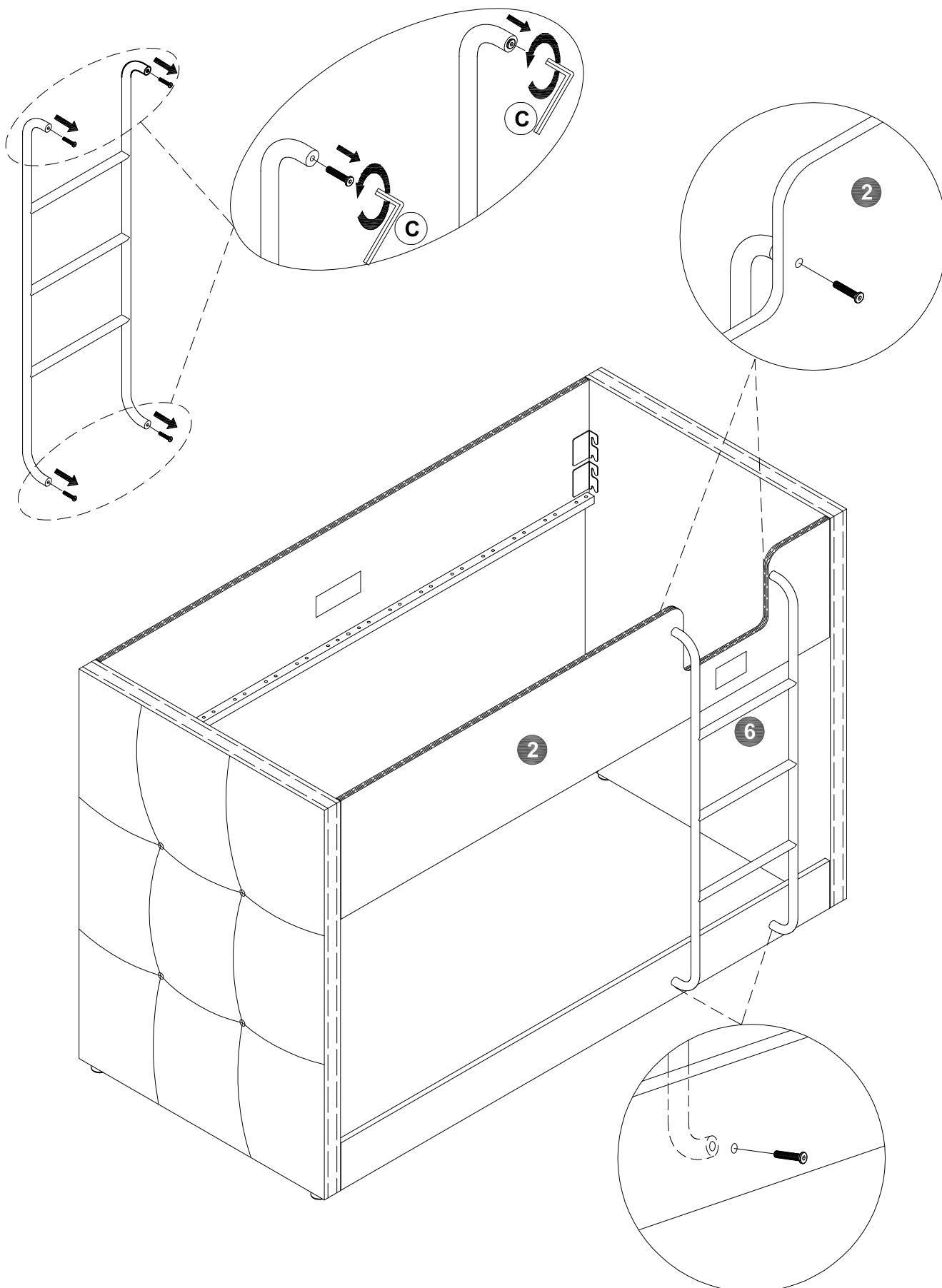

STEP 4

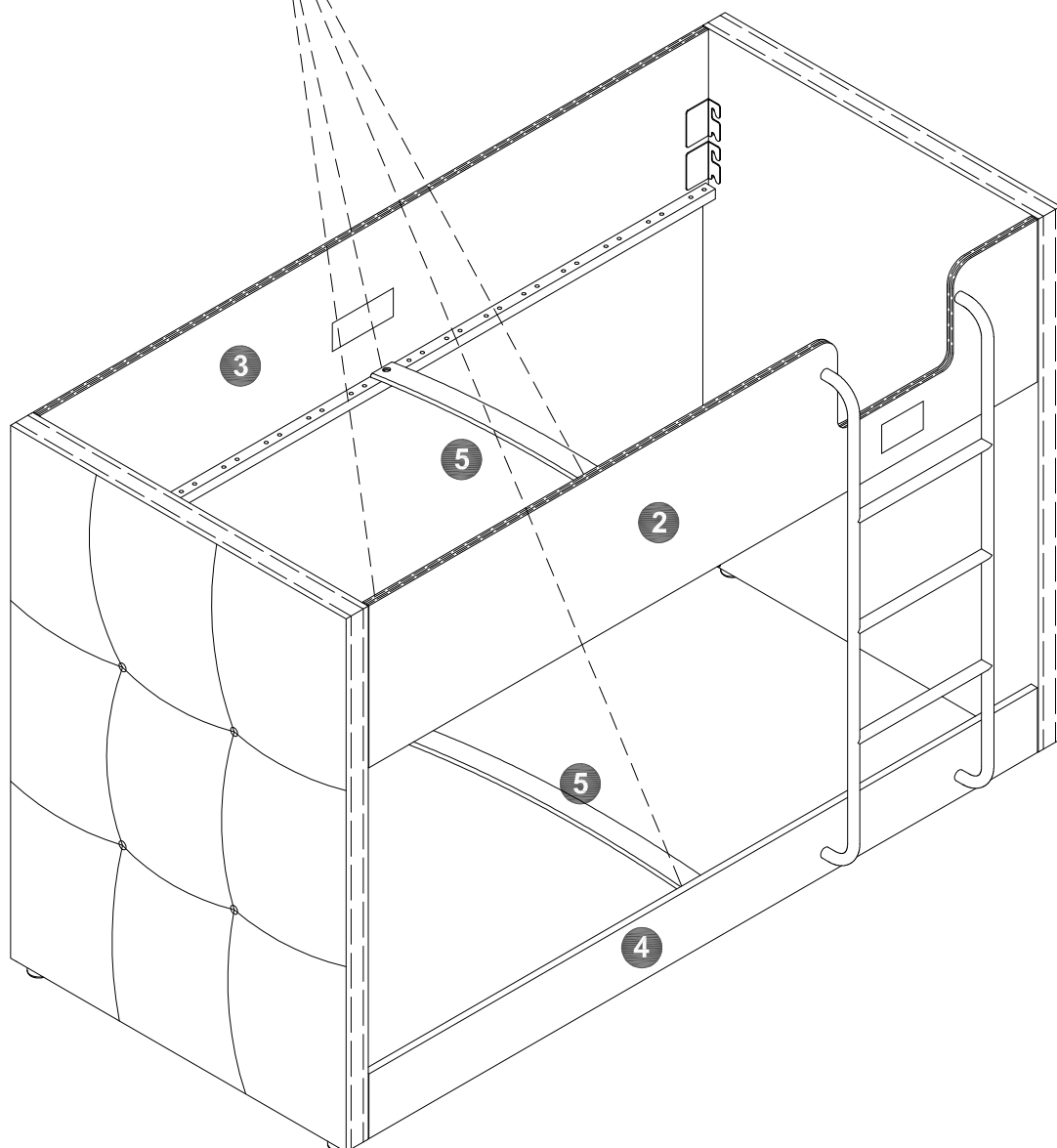
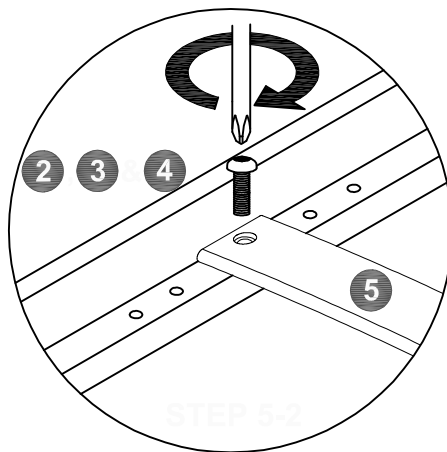
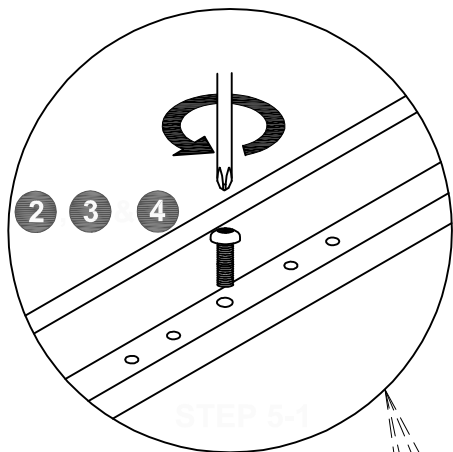

STEP 5

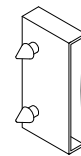

A x 64

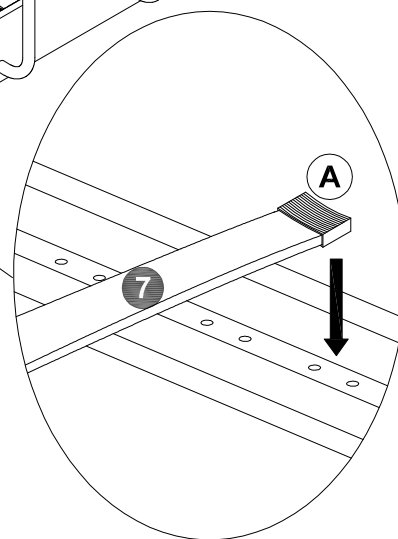
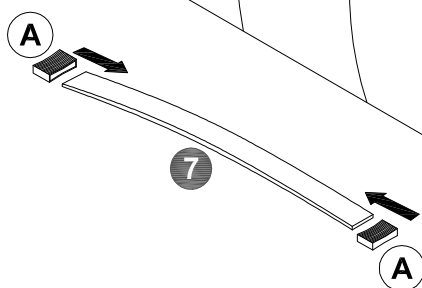
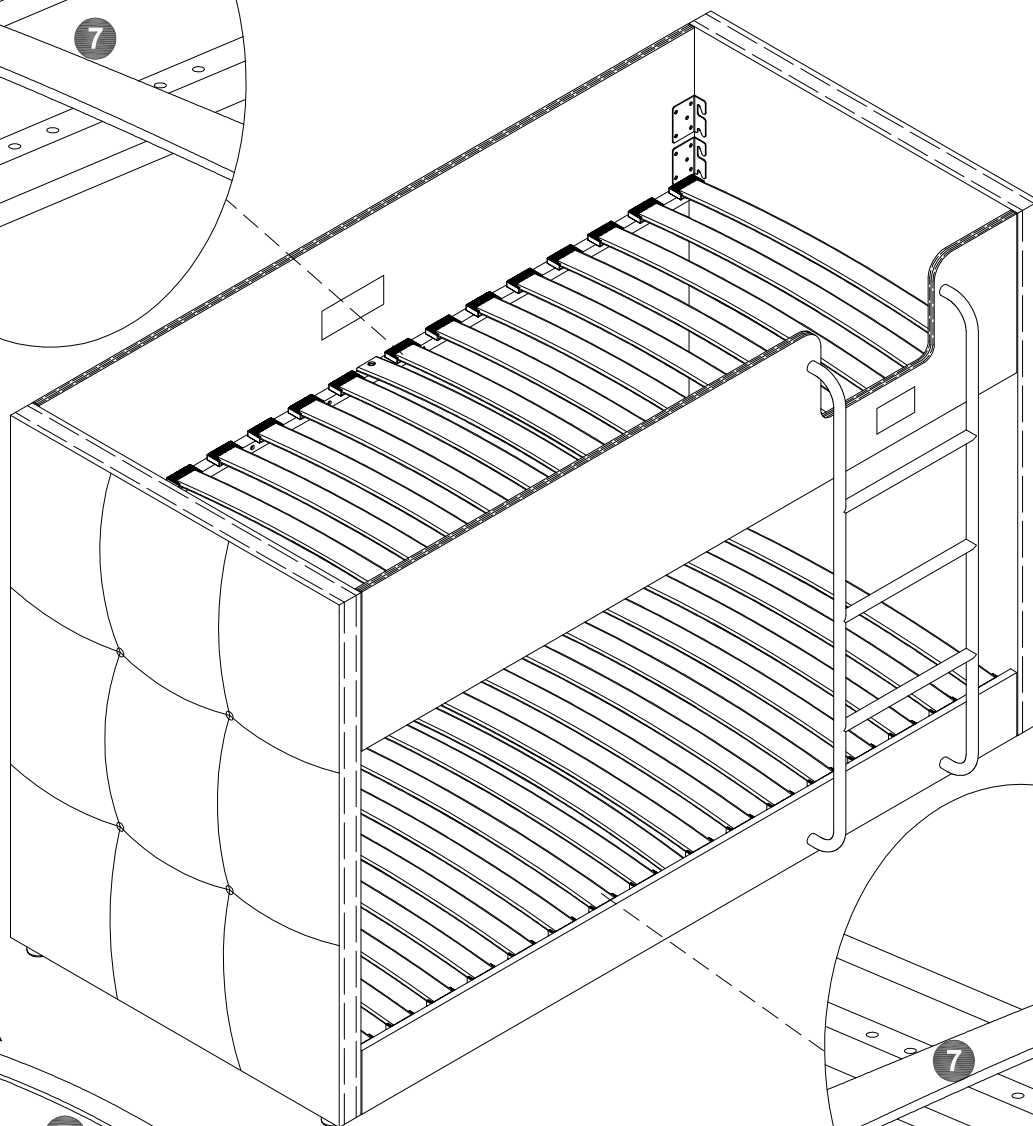
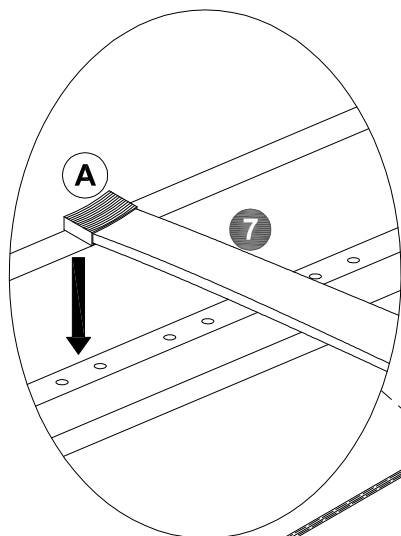

STEP TO REMOVE SLAT CAP :

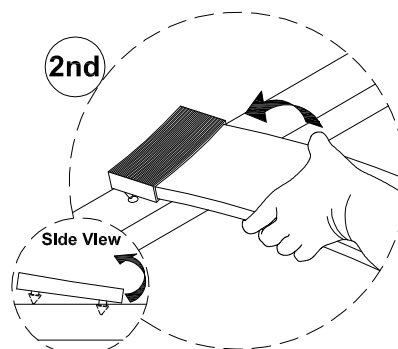
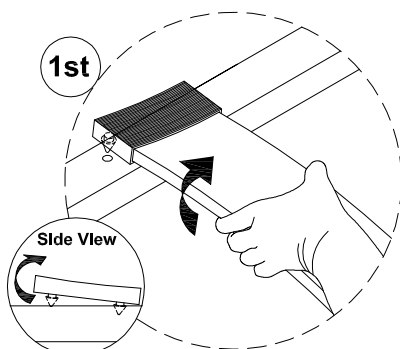

STEP 6

ATTENTION!
MAXIMUM MATTRESS HEIGHT
IMPORTANT SAFETY WARNING !
DO NOT PLACE THE MATTRESS ABOVE THE LINE MARKED
AND DO NOT REMOVE THIS LABEL

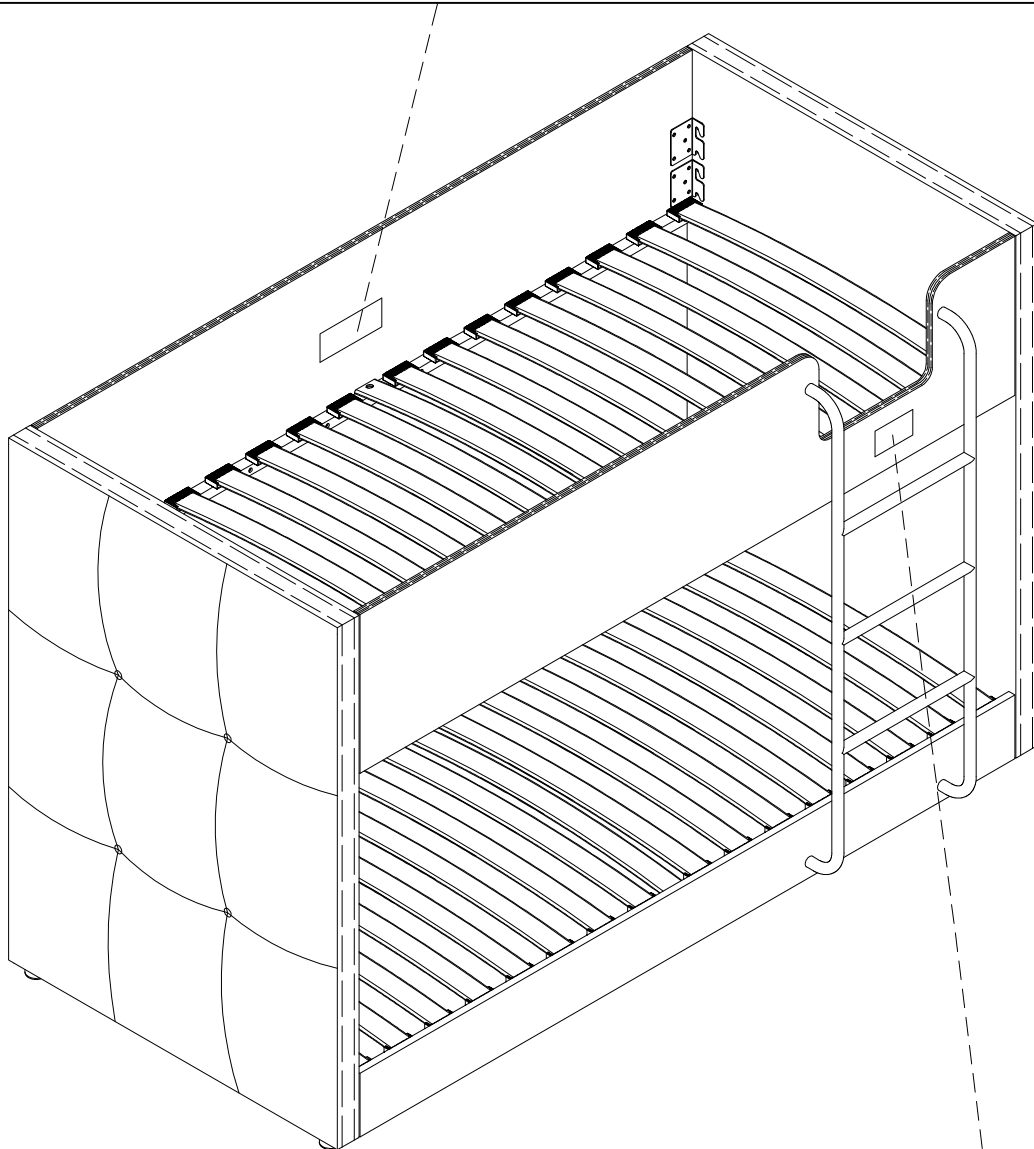

WARNING!

WE WOULD RECOMMEND THAT
CHILDREN UNDER 6 YEARS OF AGE
ARE NOT ALLOWED TO SLEEP OR PLAY IN
ANY BUNK BED

**This product complies with
EN747-1:2012+A1:2015**