

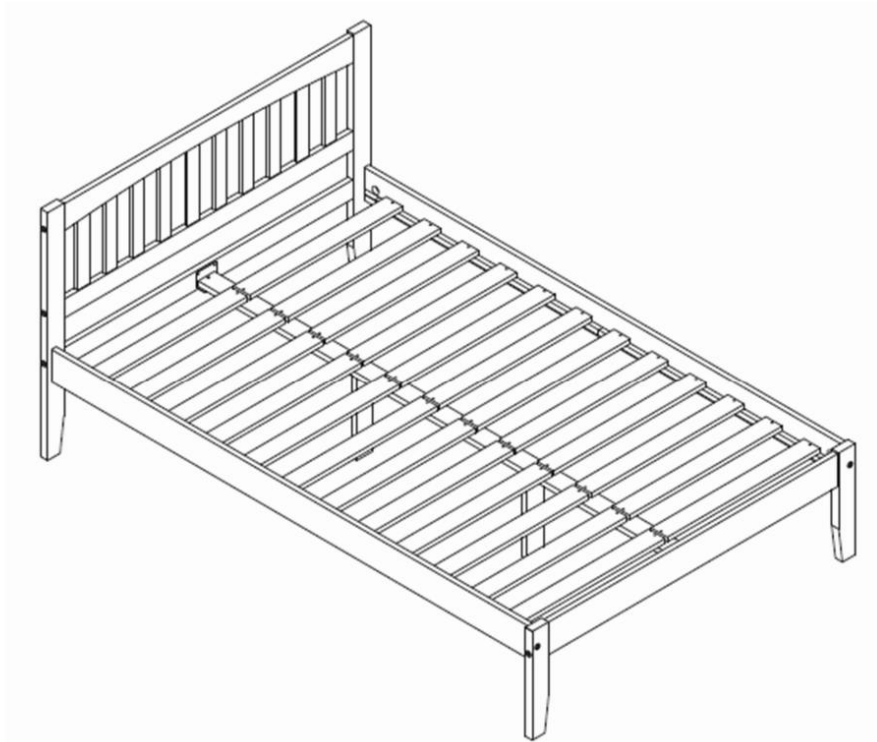

Assembly Instructions

Porto Bed



Important before assembly:

Read these instructions carefully before assembling or using the product.

Please check the contents of the boxes before attempting to assemble this product. The instructions will have a checklist of parts and fittings.

It would be sensible to lay a rug or a carpet on the floor where you intend to assemble the product, to void scratches and damaging the product or the floor.

Assemble the product as close to its intended final location/room as possible.

Do NOT use any power tools as this may damage the frame.

Health & Safety:

This product or some parts of this product will be heavy. Please use an assistant when lifting.

DO NOT jump on the product or any of its parts.

DO NOT use this product if any parts are missing, damaged or worn.

DO NOT use this product unless all fixings are secured.

Please keep small parts out of reach of children.

Always use on a level, even surface.

Please keep these instructions for future reference.

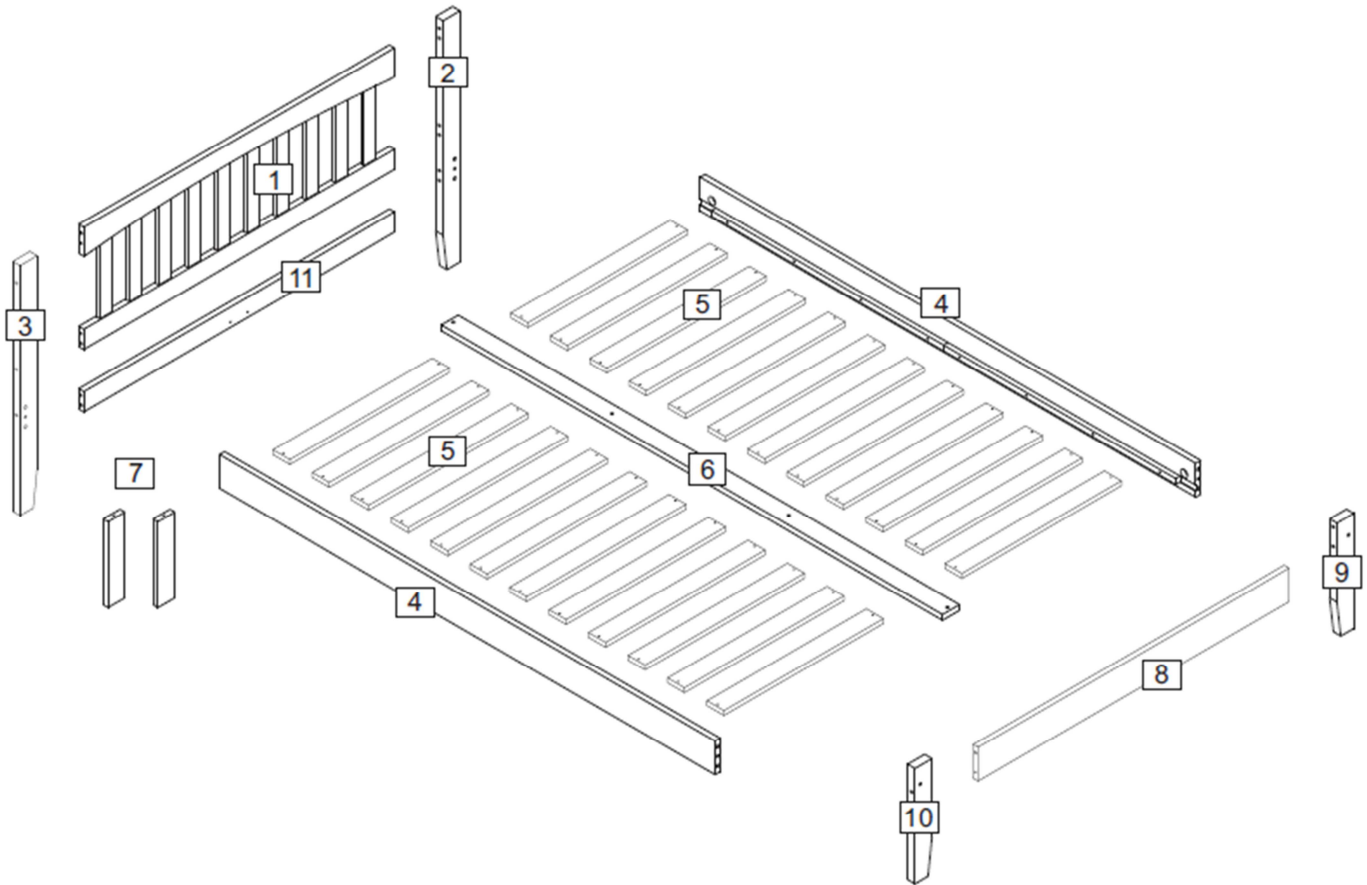

Parts List				Hardware List (found in Box 1)		
Part	Description	Box	Qty	Part	Description	Qty
1	Headend Panel	1	1	A	30 mm Wooden Dowel 	8
2	Right Headend Post	2	1	B	40 mm Wooden Dowel 	8
3	Left Headend Post	2	1	C	16 mm Screw 	8
4	Side Rail	2	2	D	30 mm Screw 	48
5	Slat	1	24	E	32 mm Bolt 	2
6	Centre Rail	2	1	F	Nut 	2
7	Support Leg	2	2	G	50 mm Bolt 	2
8	Footend Panel	2	1	H	110 mm Bolt 	8
9	Right Footend Post	1	1	J	70 mm Bolt 	4
10	Left Footend Post	1	1	K	Elliptical Nut 	4
11	Headend Rail	1	1	L	Metal Bracket 	2
** You will need a screwdriver, small mallet and M11 spanner (not provided).				M	Allen Key 	1
				N	Spacer 	2

Step 1: Attach the support legs (7) to the centre rail (6) using hardware parts G and M. Insert hardware part B to the side rails (4) using a small mallet (not provided).

DO NOT use any power tools as this may damage the frame and will invalidate any claim.

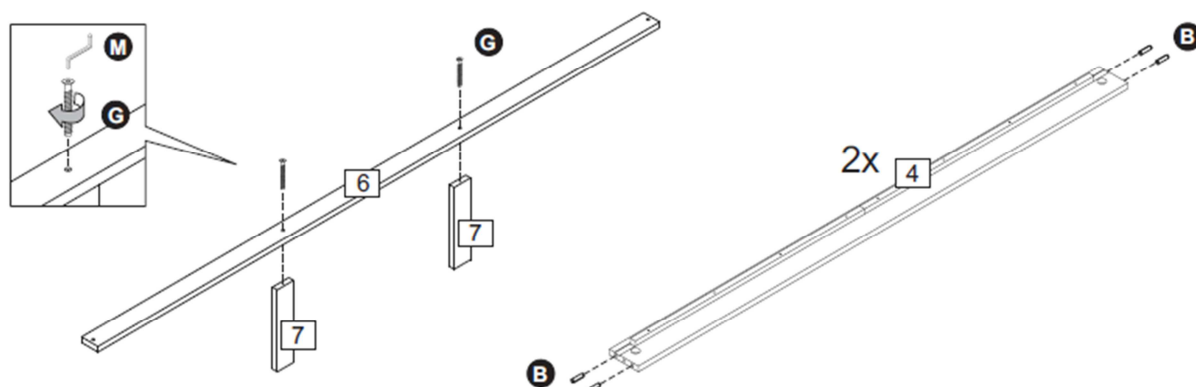

Step 2: Insert hardware part A to the headend panel (1), footend panel (8) and headend rail (11) using a small mallet (not provided).

DO NOT use any power tools as this may damage the frame and will invalidate any claim.

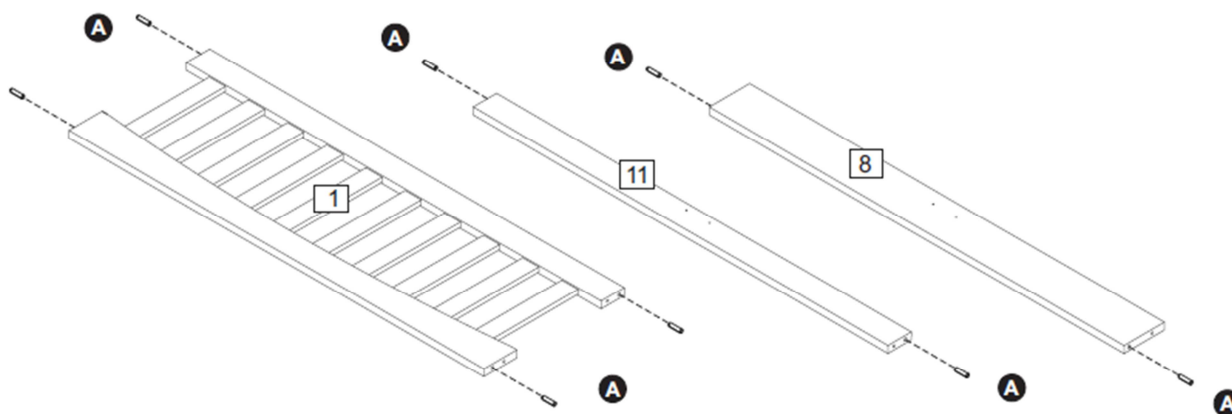

Step 3: Attach the right headend post (2) and left headend post (3) to the headend panel (1) and headend rail (11) using hardware parts H and M.

DO NOT use any power tools as this may damage the frame and will invalidate any claim.

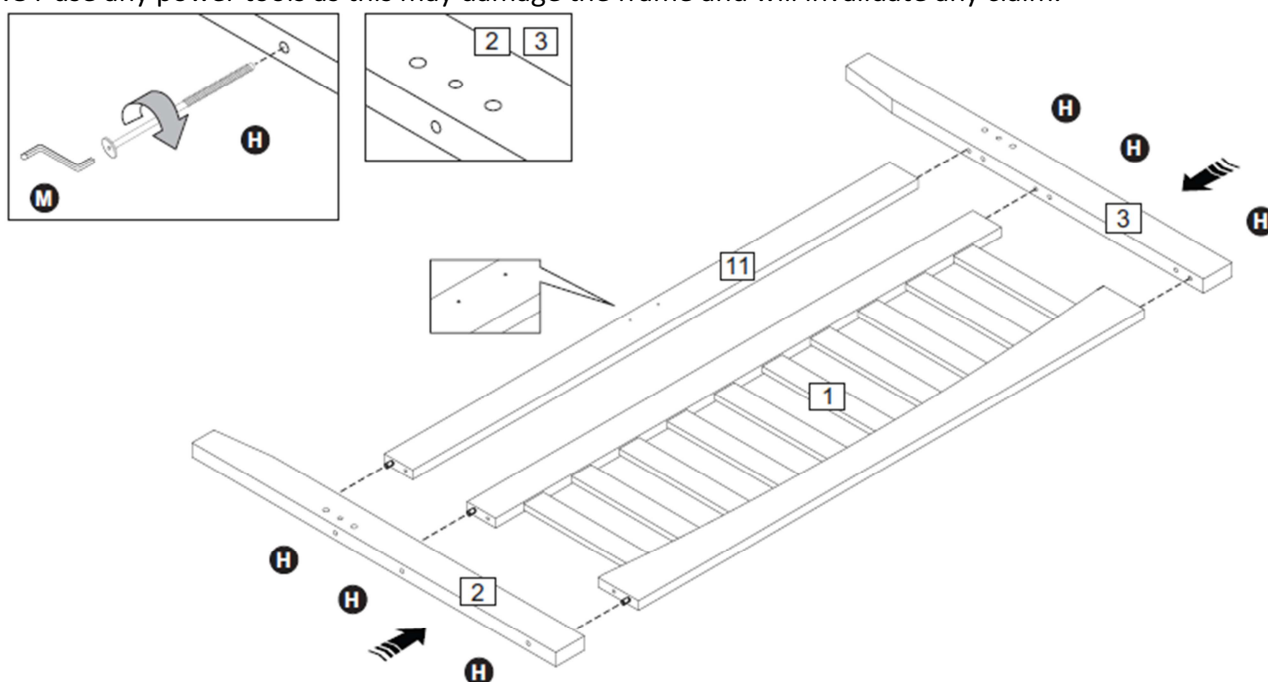

Step 4: Attach the right footend post (9) and left footend post (10) to the footend panel (8) using hardware parts H and M.

DO NOT use any power tools as this may damage the frame and will invalidate any claim.

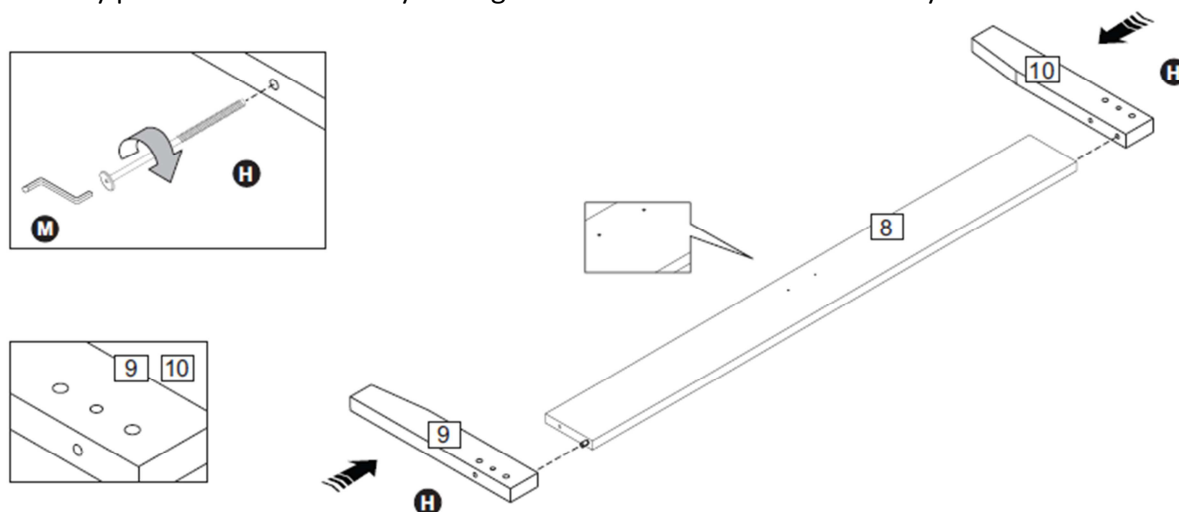

Step 5: Fix hardware part L to the headend rail (11) and footend panel (8) using hardware part C and a screwdriver (not provided).

DO NOT use any power tools as this may damage the frame and will invalidate any claim.

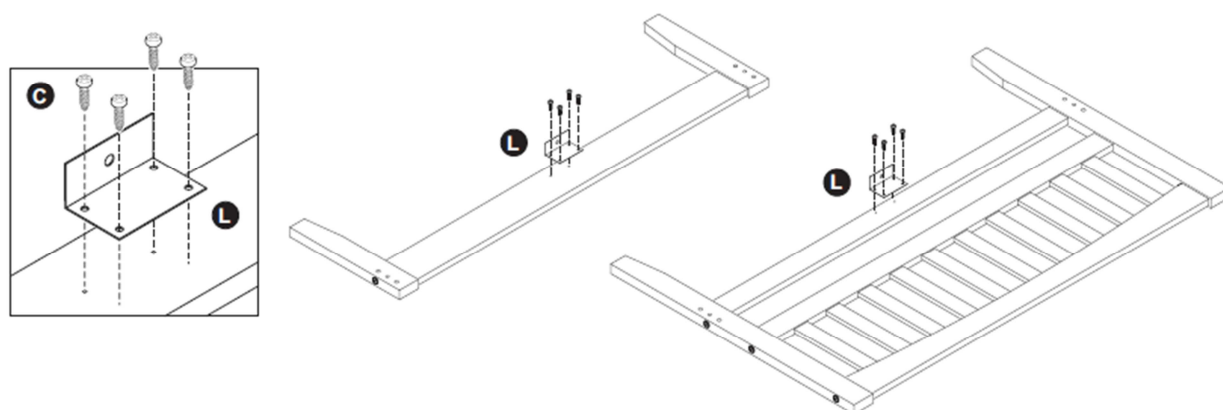

Step 6: Attach the side rails (4) using hardware part J, K and M. Fix the centre rail (6) using hardware parts E and F with an M11 spanner (not provided).

DO NOT use any power tools as this may damage the frame and will invalidate any claim.

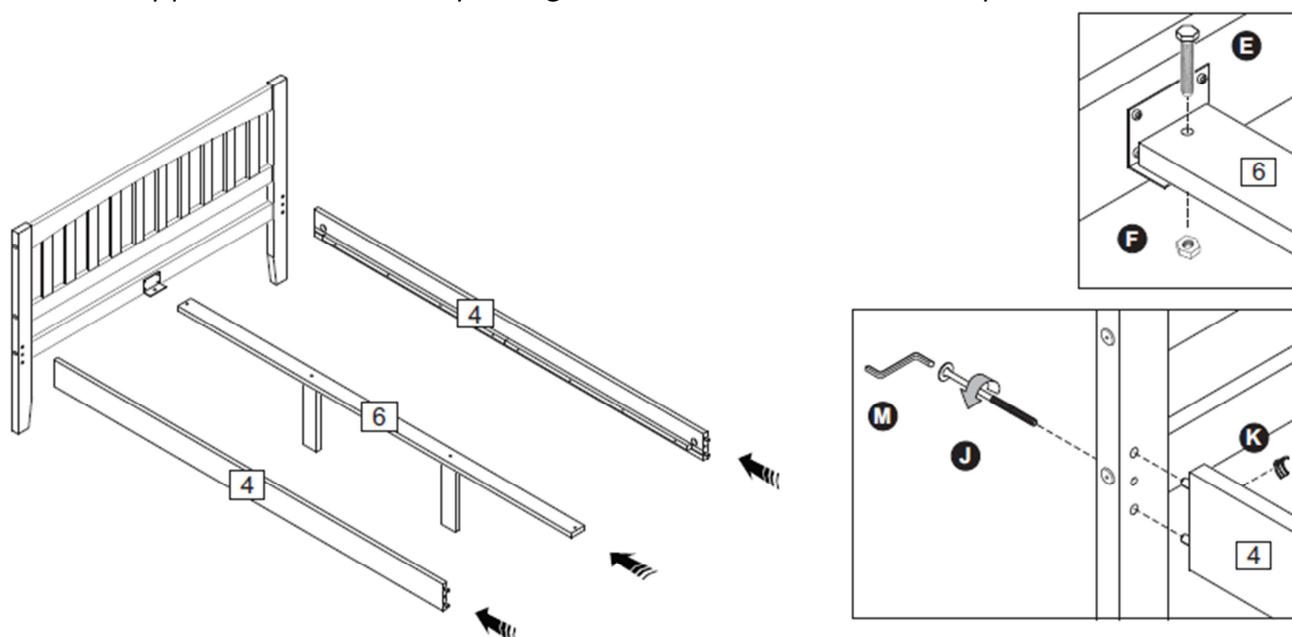

Step 7: Attach the footend using hardware parts J, K and M. Fix the centre rail (6) in place using hardware parts E and F with an M11 spanner (not provided).

DO NOT use any power tools as this may damage the frame and will invalidate any claim.

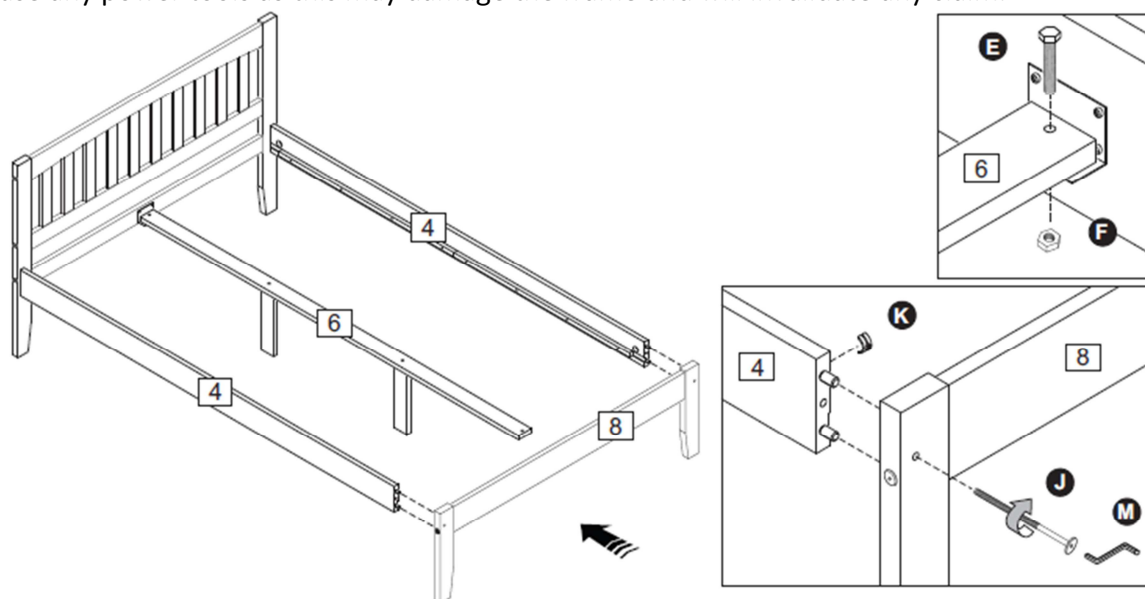

Step 8: Secure the slats (5) in position to the side rails (4) and centre rail (6) using hardware parts D and N with a screwdriver (not provided) making sure to start from the ends and work towards the middle.

DO NOT use any power tools as this may damage the frame and will invalidate any claim.

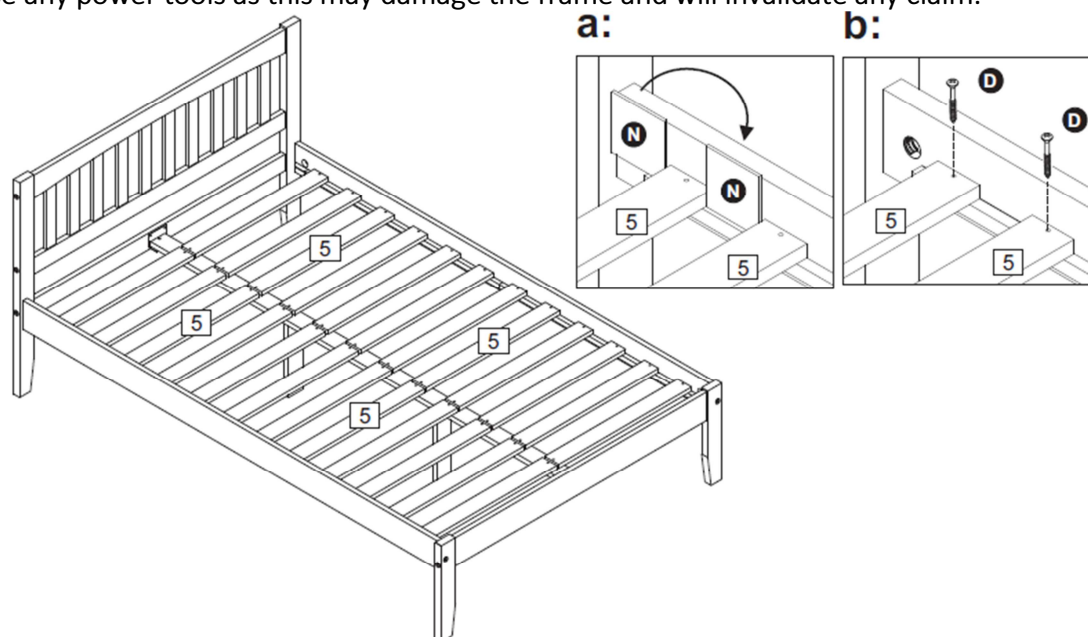

Please dispose of all packaging safely.

General Care & Maintenance

Wipe clean with a slightly damp cloth.

Avoid the use of all household cleaners and abrasives.

Periodically check all screw & fixings to ensure they are secure.

When moving your product, carefully lift into place. Never drag or push the pieces across the floor as this will cause damage to the joints and could result in failure to the product that will invalidate the warranty.

For more information on cleaning and product care visit:

<https://www.happybeds.co.uk/help-and-advice>

Notes

We've tried to make this product as easy to assemble as possible. In the unlikely event that you have problems putting it together or have damaged or missing pieces, please contact us by visiting:

<https://www.happybeds.co.uk/customer-service>



www.happybeds.co.uk

